

SIMPLY LEVEL



INDEX

1. Code Registry
2. Use
3. Technical Specification

1. CODE REGISTRY

| Code | Description | Colour | (mm) | Weight | Bag / Pkg. / Pallet |
|---------------|---|--------|------|--------------|-------------------------------|
| TER04-4410DK | Cylinder Simply Level | Blue | - | 0,93 kg/bag | 50 pcs. / 10 bags / 150 bags |
| TER04-4401DK | Disposable screw 1 mm for cylinder system | White | 1 | 0,300 kg/bag | 100 pcs. / 30 bags / 450 bags |
| TER04-44015DK | Disposable screw 1,5 mm for cylinder system | White | 1,5 | 0,300 kg/bag | 100 pcs. / 30 bags / 450 bags |
| TER04-4402DK | Disposable screw 2 mm for cylinder system | White | 2 | 0,300 kg/bag | 100 pcs. / 30 bags / 450 bags |
| TER04-4403DK | Disposable screw 3 mm for cylinder system | White | 3 | 0,300 kg/bag | 100 pcs. / 30 bags / 450 bags |
| TER04-4421DK | Cross Spacer Screw 1 mm for cylinder system | White | 1 | 0,300 kg/bag | 100 pcs. / 30 bags / 450 bags |
| TER04-4422DK | Cross Spacer Screw 2 mm for cylinder system | White | 2 | 0,300 kg/bag | 100 pcs. / 30 bags / 450 bags |
| TER04-4423DK | Cross Spacer Screw 3 mm for cylinder system | White | 3 | 0,300 kg/bag | 100 pcs. / 30 bags / 450 bags |
| TER04-4431DK | T Spacer Screw 1 mm for cylinder system | White | 1 | 0,300 kg/bag | 100 pcs. / 30 bags / 450 bags |
| TER04-4432DK | T Spacer Screw 2 mm for cylinder system | White | 2 | 0,300 kg/bag | 100 pcs. / 30 bags / 450 bags |
| TER04-4433DK | T Spacer Screw 3 mm for cylinder system | White | 3 | 0,300 kg/bag | 100 pcs. / 30 bags / 450 bags |
| TER04-4410DD | Cross Anti Scratch Pad | Black | - | 0,930 kg/bag | 50 pcs. / 10 bags / 300 bags |

MATERIAL

Made of PP (polypropylene).

TER04-4410DK

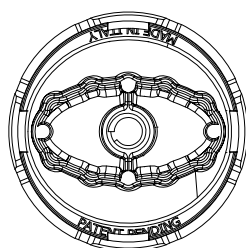
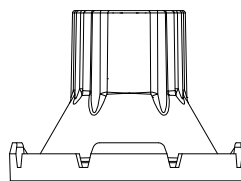
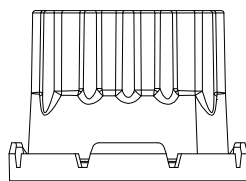

SIMPLY LEVEL

**TER04-4401DK
TER04-44015DK
TER04-4402DK
TER04-4403DK**

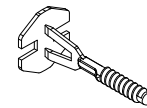
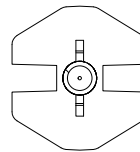
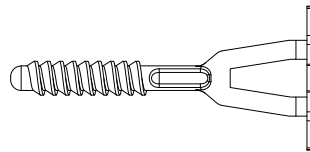
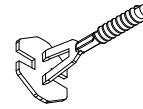
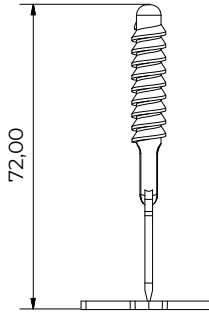

**TER04-4421DK
TER04-4422DK
TER04-4423DK**

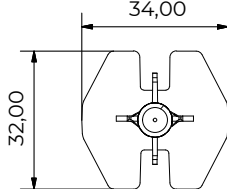
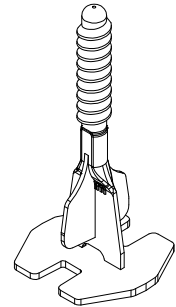
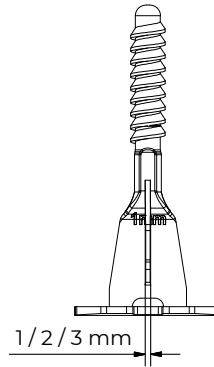
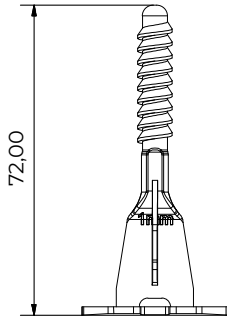

**TER04-4431DK
TER04-4432DK
TER04-4433DK**

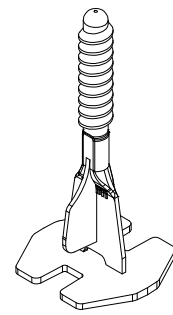
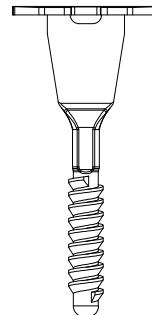
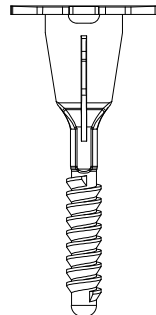

SIMPLY LEVEL

TER04-4410DD

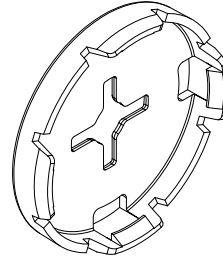
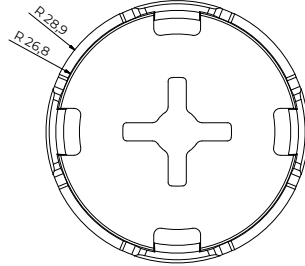
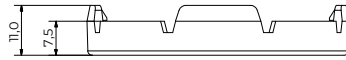

2. USE

Used as leveling system for flooring, facade tiles and coatings of various sizes and thicknesses, especially for large ones.

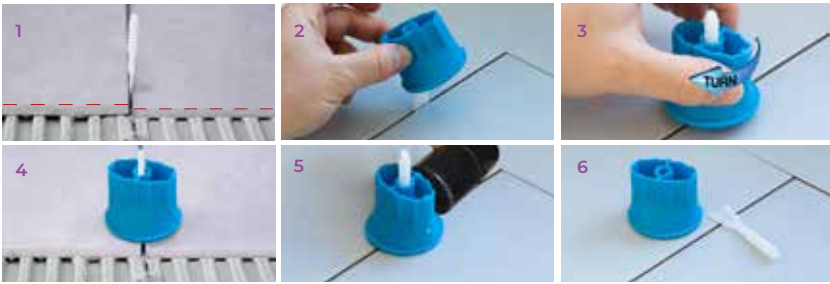

| | | | | | | | | | | | | | | |
|-----|-----|----|----|----|----|----|----|----|----|----|----|-----|-----|---|
| A | | | | | | | | | | | | | | |
| 10 | 200 | | | | | | | | | | | | | |
| 15 | 133 | 89 | | | | | | | | | | | | |
| 20 | 100 | 67 | 50 | | | | | | | | | | | |
| 25 | 80 | 53 | 40 | 32 | | | | | | | | | | |
| 30 | 100 | 67 | 50 | 40 | 44 | | | | | | | | | |
| 40 | 75 | 50 | 37 | 30 | 33 | 25 | | | | | | | | |
| 45 | 67 | 44 | 33 | 27 | 30 | 22 | 20 | | | | | | | |
| 50 | 60 | 45 | 30 | 24 | 27 | 20 | 13 | 16 | | | | | | |
| 60 | 50 | 33 | 25 | 20 | 22 | 17 | 15 | 10 | 11 | | | | | |
| 80 | 50 | 33 | 25 | 20 | 21 | 16 | 14 | 15 | 10 | 9 | | | | |
| 90 | 44 | 30 | 22 | 18 | 19 | 14 | 12 | 15 | 9 | 8 | 7 | | | |
| 100 | 50 | 33 | 25 | 20 | 20 | 15 | 13 | 15 | 10 | 9 | 8 | 8 | | |
| 120 | 42 | 28 | 21 | 17 | 17 | 13 | 11 | 15 | 8 | 7 | 6 | 7 | 6 | |
| cm | 10 | 15 | 20 | 25 | 30 | 40 | 45 | 50 | 60 | 80 | 90 | 100 | 120 | B |



| | | | | | | | | | | | | | | |
|-----|----|----|----|----|----|----|----|----|----|----|----|-----|-----|---|
| A | | | | | | | | | | | | | | |
| 10 | 98 | | | | | | | | | | | | | |
| 15 | 65 | 43 | | | | | | | | | | | | |
| 20 | 49 | 32 | 24 | | | | | | | | | | | |
| 25 | 39 | 26 | 19 | 15 | | | | | | | | | | |
| 30 | 32 | 21 | 16 | 13 | 11 | | | | | | | | | |
| 40 | 49 | 32 | 24 | 19 | 16 | 18 | | | | | | | | |
| 45 | 43 | 29 | 21 | 17 | 14 | 16 | 14 | | | | | | | |
| 50 | 39 | 26 | 19 | 15 | 13 | 14 | 13 | 11 | | | | | | |
| 60 | 32 | 21 | 16 | 13 | 11 | 12 | 10 | 9 | 8 | | | | | |
| 80 | 36 | 24 | 18 | 14 | 12 | 12 | 10 | 9 | 8 | 7 | | | | |
| 90 | 32 | 21 | 16 | 13 | 11 | 10 | 9 | 8 | 7 | 6 | 6 | | | |
| 100 | 29 | 19 | 14 | 11 | 9 | 9 | 8 | 7 | 6 | 6 | 5 | 4 | | |
| 120 | 32 | 21 | 16 | 13 | 11 | 10 | 9 | 8 | 6 | 6 | 5 | 4 | 4 | |
| cm | 10 | 15 | 20 | 25 | 30 | 40 | 45 | 50 | 60 | 80 | 90 | 100 | 120 | B |



LINEAR

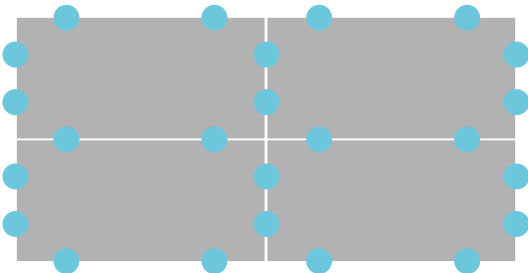

CORNER

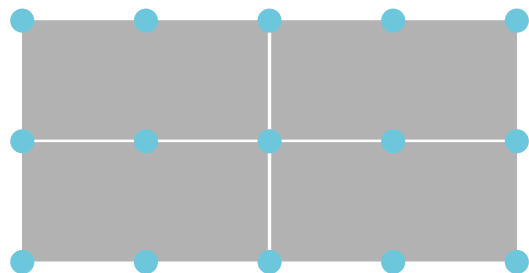

SIMPLY LEVEL

3. TECHNICAL SPECIFICATION

| Specification | Description | Unity | Price |
|----------------------------|---|-------|-------|
| Dak.I.TER04.44xxDx | Supply and installation of kit composed of two assembled elements (cylinder and screw). A system composed of 2 elements (cylinder and spacer screw) that assembled and adjusted, allows, to remove any difference between tile and tile during the laying, obtaining a coplanar and equidistant result without any lippage. Spacer Screw are available for 1, 1.5, 2, 3 mm grout joints. Cross and T Spacer Screw are available for 1, 2, 3 mm grout joints. Scratch Proof Disc is an optional supplied in 50 pcs./bag. Made of PP (polypropylene) and PP (polypropylene homopolymer). Used as leveling system for flooring, facade tiles and coatings of various sizes and thicknesses, especially for large ones. | | |
| Dak.I.TER04.4410DK | Cylinder - Blue..... | bags. | - |
| Dak.I.TER04.4401DK | Spacer screw 1 mm for cylinder system..... | bags. | - |
| Dak.I.TER04.44015DK | Spacer screw 1,5 mm for cylinder system..... | bags. | - |
| Dak.I.TER04.4402DK | Spacer screw 2 mm for cylinder system..... | bags. | - |
| Dak.I.TER04.4403DK | Spacer screw 3 mm for cylinder system..... | bags. | - |
| Dak.I.TER04.4421DK | Cross spacer screw 1 mm for cylinder system..... | bags. | - |
| Dak.I.TER04.4422DK | Cross spacer screw 2 mm for cylinder system..... | bags. | - |
| Dak.I.TER04.4423DK | Cross spacer screw 3 mm for cylinder system..... | bags. | - |
| Dak.I.TER04.4431DK | T spacer screw 1 mm for cylinder system..... | bags. | - |
| Dak.I.TER04.4432DK | T spacer screw 2 mm for cylinder system..... | bags. | - |
| Dak.I.TER04.4433DK | T spacer screw 3 mm for cylinder system..... | bags. | - |
| Dak.I.TER04.4410DD | Cross Anti Scratch Pad..... | bags. | - |