

# ENDING PROFILE WITH MESH

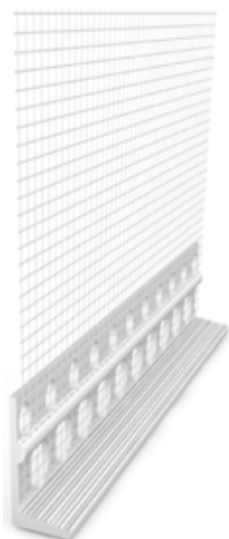

## INDEX

1. Code registry
2. Description
3. Use
4. Technical specification

## 1. CODE REGISTRY

Code	Description	Measure (mm)	Weight (kg)	Colour	Pkg. / Pallet
ZIN33-1671/3	Ending profile with mesh	h. 3,0 x 2.000	4,80	White	50 m / 45 cf.
ZIN33-1671/6	Ending profile with mesh	h. 6,0 x 2.000	5,00	White	50 m / 45 cf.
ZIN33-1671/10C	Ending profile with mesh	h. 10,0 x 2.000	5,20	White	50 m / 45 cf.
ZIN33-1671/10CX	Ending profile with mesh	h. 10,0 x 2.500	6,50	White	62,5 m / 45 cf.
ZIN33-1671/15	Ending profile with mesh	h. 15,0 x 2.000	5,00	White	50 m / 45 cf.
ZIN33-1671/15/3	Ending profile with mesh	h. 15,0 x 3.000	7,50	White	75 m / 50 cf.
ZIN33-1671/3X	Ending profile with mesh	h. 3,0 x 2.500	6,00	White	62,5 m / 45 cf.
ZIN33-1671/6CX	Ending profile with mesh	h. 6,0 x 2.500	5,00	White	62,5 m / 55 cf.

**MATERIAL** Made of PVC and fiberglass mesh

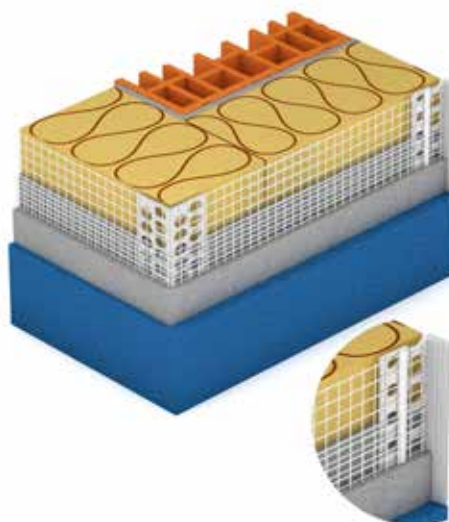

# ENDING PROFILE WITH MESH

## 2. DESCRIPTION

Ending plaster profile, available in different thicknesses, with heat-sealed fiberglass mesh R131

## 3. USE

Utilized for a correct and uniform application of the leveller in the insulation systems or plaster and to realize sharp edges in the closing of the levelled surface.

## 4. TECHNICAL SPECIFICATION

Code	Description	Unit	Price
<b>Dak.B.ZIN33.1671/x</b>	Fornitura e posa in opera di Profilo di chiusura intonaco, di differenti spessori, con rete in fibra di vetro R131 termosaldata. Realizzato in PVC e rete in fibra di vetro. Utilizzato per una corretta ed uniforme applicazione del rasante nei sistemi a cappotto o dell'intonaco e per realizzare bordi netti a chiusura della superficie rasata.		
<b>Dak.B.ZIN33.1671/3</b>	Dimensioni h. 3,0 x 2.000 mm.....	cf.	-
<b>Dak.B.ZIN33.1671/6</b>	Dimensioni h. 6,0 x 2.000 mm.....	cf.	-
<b>Dak.B.ZIN33.1671/10C</b>	Dimensioni h. 10,0 x 2.000 mm.....	cf.	-
<b>Dak.B.ZIN33.1671/10CX</b>	Dimensioni h. 10,0 x 2.500 mm.....	cf.	-
<b>Dak.B.ZIN33.1671/15</b>	Dimensioni h. 15,0 x 2.000 mm.....	cf.	-
<b>Dak.B.ZIN33.1671/15/3</b>	Dimensioni h. 15,0 x 3.000 mm.....	cf.	-
<b>Dak.B.ZIN33.1671/3X</b>	Dimensioni h. 3,0 x 2.500 mm.....	cf.	-
<b>Dak.B.ZIN33.1671/6cx</b>	Dimensioni h. 6,0 x 2.500 mm.....	cf.	-