

SLOTTED CAST IRON ANTI-HEEL GRATING 130



INDEX

1. Code Registry
2. Description
3. Use
4. Technical Specification

1. CODE REGISTRY

Code	Description	Dimension (mm)	Weight	Colour	Pkg. / Pallet
POZ90-1351HBN	B125 Slotted Cast Iron Anti-heel Grating	130 x 500 x 20	2,75 kg/pc.	Black	1 pc. / 260 pcs
POZ90-1351HCN	C250 Slotted Cast Iron Anti-heel Grating	130 x 500 x 20	3,50 kg/pc.	Black	1 pc. / 260 pcs

MATERIAL Made of spheroidal cast iron.

CERTIFICATION EU regulation UNI 1433.

POZ90-1351HBN

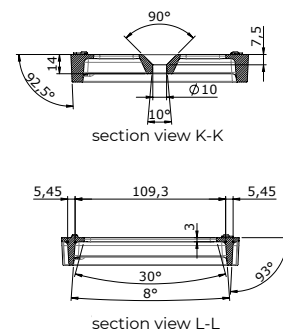
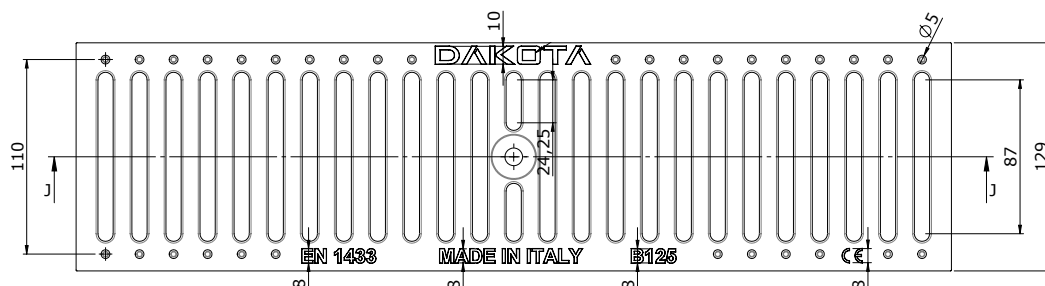

POZ90-1351HCN

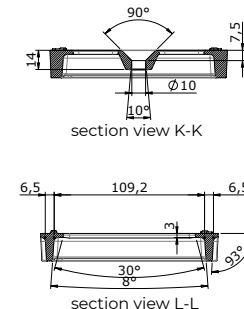
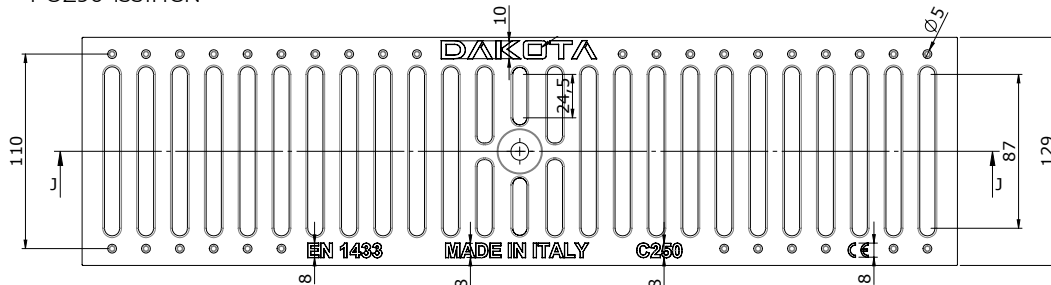

SLOTTED CAST IRON ANTI-HEEL GRATING 130

2. DESCRIPTION

Grating for Dakota Channels with heel proof mesh design. Available load class: B125 and C250

3. USE

It can be used in areas that need high load capacity (heavy traffic and/or heavy vehicles passage, respecting the corresponding loading class).

4. TECHNICAL SPECIFICATION

Specification	Description	Unity	Price
Dak.D.POZ90.135IHx	Supply and installation to Made with Anti-heel slotted design. Available loading classes: B125 - C250. Made of spheroidal cast iron. It can be used in areas that need high load capacity (heavy traffic and/or heavy vehicles passage, respecting the corresponding loading class).		
Dak.D.POZ90.135IHBN	Class B125.....	pc.	-
Dak.D.POZ90.135IHCN	Class C250.....	pc.	-