

# STEEL JOIST OF MAGNELIS® AND ADAPTER IN PP



## INDEX

1. Code Registry
2. Description
3. Use
4. Technical drawings
5. Magnelis® features
6. Technical Specification

## 1. CODE REGISTRY

Code	Description	Dimension (mm)	Weight (kg/pc.)	Pkg. / Pallet
TER09-1149ZM2	Steel Joist	40 x 30 x 2.000	2	1 pc. / 200 pcs.
TER09-1151 *	Adapter for Steel Joist	-	0,02	30 pcs. / 3.780 pcs.
TER09-1149/G	Anti-noise adhesive rubber tape	8 mm x 10 m	0,020	35 pcs./180 pcs.
TER09-1151GR	Joist Connector	-	0,015 kg/pz.	60 pcs. / 7.560 pcs.
TER09-1149/A	Paving Cross Spacer 4mm for Magnelis®	-	0,010 kg/pz.	150 pcs.. / 144 pcs
TER09-1149/B	Lateral wall spacer for Magnelis®	-	0,008 kg/pz.	90 pcs. / 144 pcs.
TER09-1149/C	"T" connector for Magnelis®	-	0,015 kg/pz.	120 pcs. / 144 pcs.
MIN01-5200P	Fixala - Black phosphate bugle head self screwing screws - nail tip screw and adapter	ø 3,5 x 25	1,36 kg/cf.	1.000 pcs. / 384.000 pcs.

\* Accessory not compatible with Arkimedes 10

**MATERIAL** The adapter is made of PP (polypropylene) and the joist is made of Galvanized Steel with a aluminum, zinc and magnesium coating.

## 2. DESCRIPTION

Magnelis® joist with plastic fixing insert and hooking accessory (bajonetta) for the ARKIMEDE support.

The use of the bajonetta accessory guarantees a perfect coupling with all **ARKIMEDE 18, 35, 41, 60 and 115 supports**.

The system is completed with accessories such as linear and "T" connectors, wall spacer and paving cross spacer for the equidistant laying of tiles for outdoor flooring.

## 3. USE

The system is used for the creation of substructure for the laying decking of outdoors Paving or Decking with ARKIMEDE supports. The insertion of the "V" insert in the appropriate shape of the joist and its subsequent fixing, through self-drilling screws, guarantees perfect locking.

The recommended spacing of the ARKIMEDE supports on the Magnelis® joist is 50 cm.

# STEEL JOIST OF MAGNELIS® AND ADAPTER IN PP

## 4. TECHNICAL DRAWINGS

TER09-1151

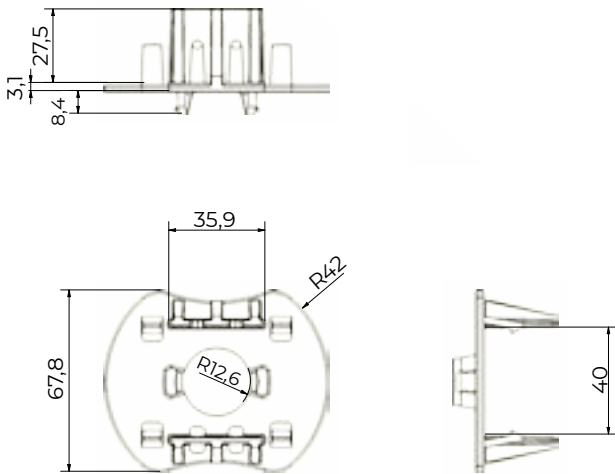

TER09-1149ZM2

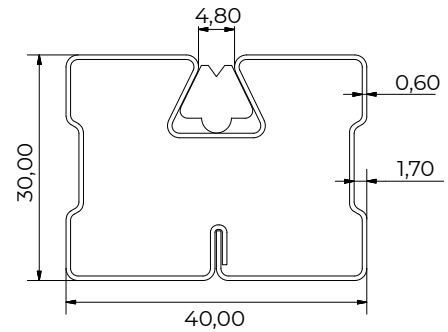

TER09-1149/A

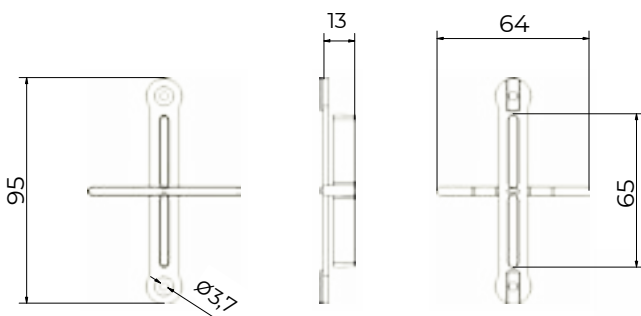

TER09-1149/B

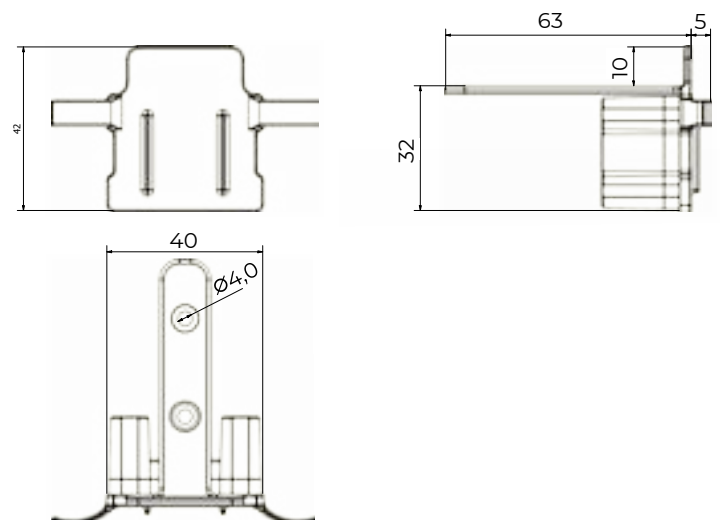

# STEEL JOIST OF MAGNELIS® AND ADAPTER IN PP

TER09-1149/B

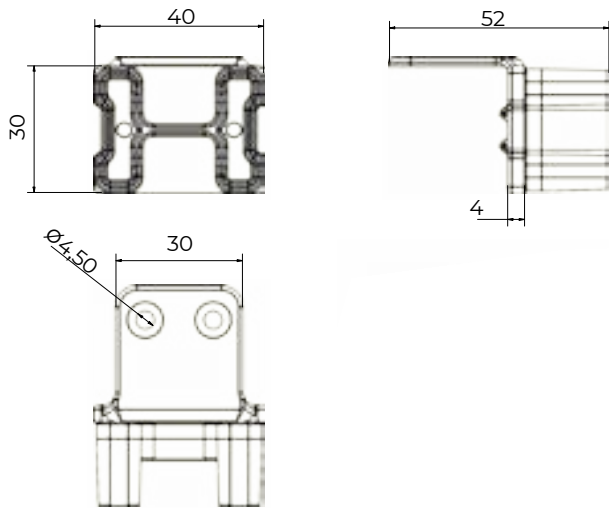

TER09-1151/GR

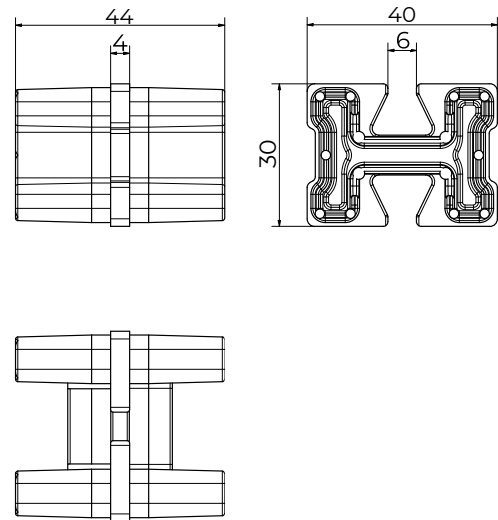

## 5. MAGNELIS® FEATURES

Magnelis® is a flat carbon steel coated on both sides with a zinc-aluminium-magnesium alloy\*

Magnelis® is an exceptional metallic coating which provides a breakthrough in corrosion protection and is the best choice for a wide variety of applications.

Thanks to its unique composition, Magnelis® provides an unprecedented level of surface and cut-edge protection, even in the most hostile environments.

It is produced on a classic hot dip galvanising line which molten bath has a unique chemical composition including zinc, 3.5% aluminium, and 3% magnesium.

- Excellent corrosion resistance - at least 3 times better than galvanised steel in external applications
- Complete edge protection thanks to the self-healing properties of Magnelis® on cut edges
- Outstanding resistance in harsh environments (maritime, chloride, and ammonia atmospheres)
- More cost-effective than batch galvanised steels due to simple manufacturing
- Reduced maintenance costs compared to post painting

The excellent corrosion resistance properties of Magnelis® have been accredited with a Preliminary Technical Evaluation of Material (ETPM) by CSTB (Centre Scientifique et Technique du Bâtiment) and certified by a number of other external bodies, among them SP (Science Partner) and DIBT (Deutsches Institut für Bautechnik).

Main features:

- Compliant with European directives: RoHS, REACH, WEEE
- EN 10346 certified
- Certified for use in the C5 environment
- Significantly lower environmental impact than competitors
- Perfect protection of the entire structure, even on uncoated edges, scratches and perforations

\* This alloy is composed of 93.5% zinc, 3.5% aluminium, and 3% magnesium.

# STEEL JOIST OF MAGNELIS® AND ADAPTER IN PP

## 6. TECHNICAL SPECIFICATION

Specification	Description	Unity	Price
<b>Dak.O.TER09-T1xx</b>	Supply and installation of Galvanized Steel Joist (2 m lenght) and plastic adapter for Arkimede Line supports. This Kit allows the making of a supporting structure for the laying of outdoor decking. The adapter is made of PP (polypropylene) and the joist is made of Galvanized Steel. This Kit allows the making of a supporting structure for the laying of outdoor decking. It is suggested to place the Arkimede support every 50 cm.		
<b>Dak.O.TER09-T149ZM2</b>	Magnelis® Steel Joist.....	pc.	-
<b>Dak.O.TER09-T151</b>	Adapter for Steel Joist.....	pc.	-
<b>Dak.O.TER09-T149/G</b>	Anti-noise adhesive rubber tape .....	pc.	-
<b>Dak.O.TER09-T151GR</b>	Joist Connector .....	pc.	-
<b>Dak.O.TER09-T149/A</b>	Paving Cross Spacer 4mm for Magnelis® .....	pc.	-
<b>Dak.O.TER09-T149/B</b>	Lateral wall spacer for Magnelis® .....	pc.	-
<b>Dak.O.TER09-T149/C</b>	"T" connector for Magnelis® .....	pc.	-
<b>Dak.O.MIN01-5200P</b>	Fixala - Black phosphate bugle head self screwing screws - nail tip screw and adapter .....	pc.	-