

# DRAINING WATER OUTLET



## INDEX

1. Code Registry
2. Use
3. Technical Specification

## 1. CODE REGISTRY

Code	Description	Dimension (mm)	Weight	Pkg. / Pallet
BOC01-1109	Draining water outlet	ø 63	0,198 kg/pcs.	25 pcs. / 150 pcs.
BOC01-1109S	Draining water outlet	ø 75	0,190 kg/pcs.	25 pcs. / 150 pcs.
BOC01-1110	Draining water outlet	ø 80	0,192 kg/pcs.	25 pcs. / 150 pcs.
BOC01-1110S	Draining water outlet	ø 90	0,193 kg/pcs.	25 pcs. / 150 pcs.
BOC01-1111	Draining water outlet	ø 100	0,195 kg/pcs.	20 pcs. / 120 pcs.
BOC01-1111S	Draining water outlet	ø 110	0,362 kg/pcs.	20 pcs. / 120 pcs.
BOC01-1112	Draining water outlet	ø 125	0,215 kg/pcs.	20 pcs. / 120 pcs.

### MATERIAL

Made of TPE (thermoplastic elastomer).

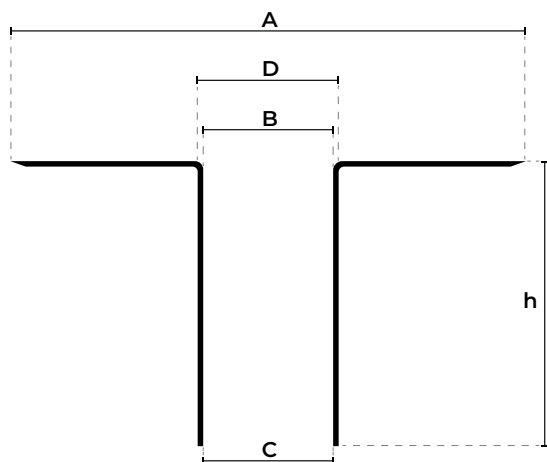

measures in mm

CODE	A	B	C	D*	h
BOC01-1109	320	50	45	51	235
BOC01-1109S	320	65	65	69	235
BOC01-1110	320	70	65	71	235
BOC01-1110S	320	80	80	86	235
BOC01-1111	320	90	90	95	235
BOC01-1111S	320	100	100	106	235
BOC01-1112	320	107	107	110	235

# DRAINING WATER OUTLET

## 2. USE

Used for vertical evacuation of rainwater in flat roofs.

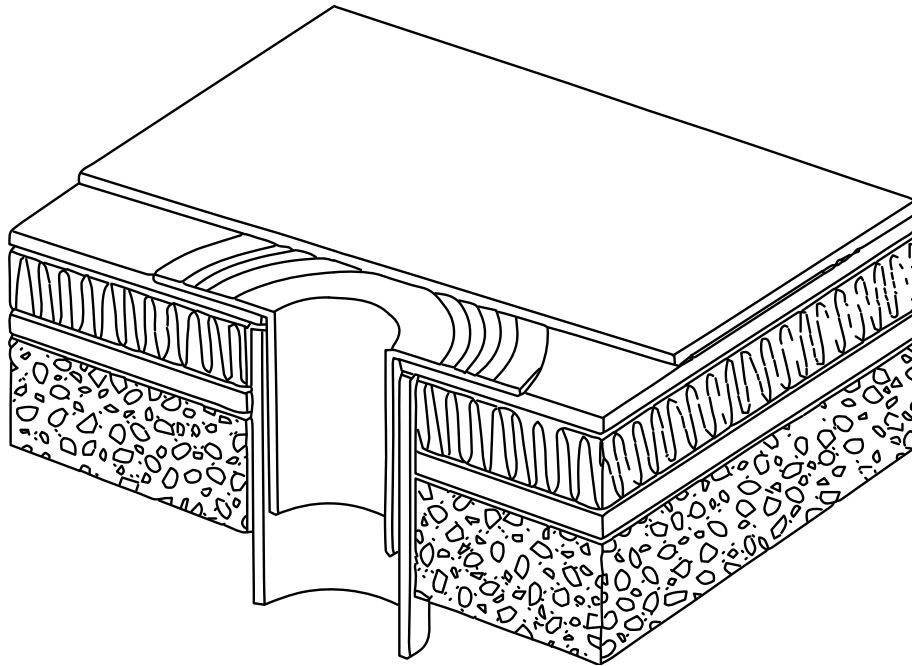

## 3. TECHNICAL SPECIFICATION

Specification	Description	Unity	Price
<b>Dak.O.BOC01.110x</b>	Supply and installation of draining water outlet consists in a flange, tube has a length of 240 mm and different diameters. Made of TPE (thermoplastic elastomer). Used for vertical evacuation of rainwater in flat roofs.		
<b>Dak.O.BOC01.1109</b>	Dimension $\varnothing$ 63 mm.....	pc.	-
<b>Dak.O.BOC01.1109S</b>	Dimension $\varnothing$ 75 mm.....	pc.	-
<b>Dak.O.BOC01.1110</b>	Dimension $\varnothing$ 80 mm.....	pc.	-
<b>Dak.O.BOC01.1110S</b>	Dimension $\varnothing$ 90 mm.....	pc.	-
<b>Dak.O.BOC01.1111</b>	Dimension $\varnothing$ 100 mm.....	pc.	-
<b>Dak.O.BOC01.1111S</b>	Dimension $\varnothing$ 110 mm.....	pc.	-
<b>Dak.O.BOC01.1112</b>	Dimension $\varnothing$ 125 mm.....	pc.	-