

PVC ANGLES MESHED OPTIMUS



INDEX

1. Code registry
2. Description
3. Use
4. Technical specification

1. CODE REGISTRY

Code	Description	Measures (mm)	Weight	Color	Pkg. / Pallet
ZIN33-1664OS	pvc corner with OPTIMUS brand white mesh	100 x 100 x 2.500	-	White	125 m / 40 cf.

MATERIAL Made of PVC and fiberglass mesh.

2. DESCRIPTION

"Open corner" angle with heat-sealed fiberglass mesh. The mesh is of the weight used for overcoating. The angle can be cut to the required length without waste.

3. USE

Used as a sealing joint between the insulation board and the cover profile for under sill, door and window marbles, shutter boxes, etc...

Applied as a reinforcement of the outer corners of houses and edges the PVC Angle with mesh allows the continuity of the mesh and greater protection of the corner itself.

It should be applied before the layer of reinforced skim coat is made.

The PVC profile with fixed inner corner should be applied on the insulating panels with skimming mass over the entire surface.

The joints should be overlapped with the mesh by 10 cm (where possible). The inner reinforcement should be pulled out for this purpose.

The layer of reinforced skim coat should be applied in strips of the width of the mesh, taking care of the overlap of at least 10 cm of the vertically adjacent mesh flaps.

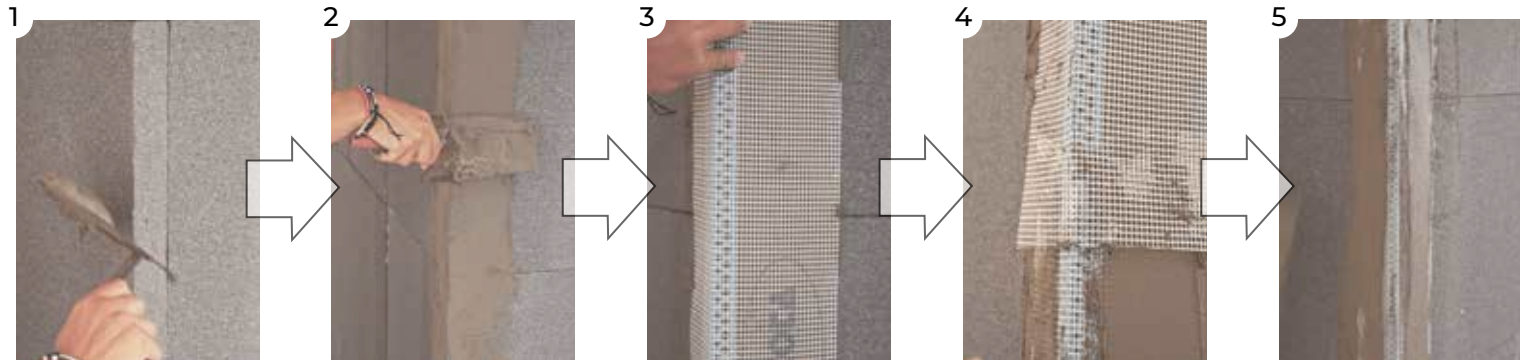

1. Apply a layer of skim coat to the insulation panels of the coat system

2. Complete the application of the skim coat over the entire surface evenly of the corner. Such treatment allows a secure adhesion of the corner to the panel.

3. Place the product until perfect adhesion on the corner..

4. Drown our corner in the skim coat. Any joints of the same should always be made for the 10 cm of overlap indicated before.

5. Complete the shaving until the work is completed according to the rule of art.

PVC ANGLES MESHED OPTIMUS

4. TECHNICAL SPECIFICATION

Item	Description	U.M.	Price
Dak.B.ZIN33.166x	<p>Supply and installation of corner edge protection with fiberglass mesh. The mesh can be the same as that used for the overcoat coating. Made of gray PVC and fiberglass mesh. The product should be laid with the mesh placed in the layer of adhesive paying close attention to the fact that it is perfectly embedded using a notched trowel or trowel for this purpose, before laying the material the substrate should be previously prepared, clean, flat and dimensionally stable. Embed the angles in the skim coat and, when hardened, cover with an additional coat of skim coat. The angle will have to be well fixed to the corner of the structure also with the adhesive, overlaps with the mesh should never be less than 10 cm. The resulting surfaces and the corner itself should be further shaved and leveled in order to receive, after curing, the additional coat of gravel plaster and paint. Used to maintain uniform laying of the mesh in this way uniform tensile strength is maintained to the entire structure of the building insulation package. On site, the product should be delivered in cardboard boxes, bearing a control code.</p>		
Dak.B.ZIN33.1664OS	Dimensions 100 x 100 x 2.500 mm.....	cf.	-