

PVC 3D PLUS WINDOW PROFILE WITH MESH

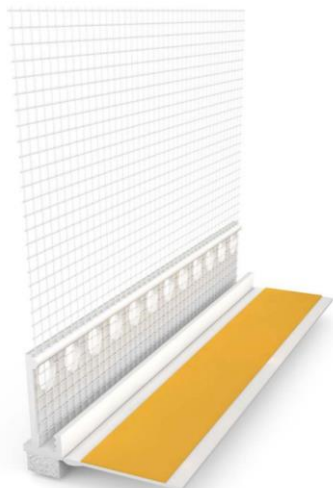

INDEX

1. Data and Documentation
2. Description
3. Use
4. Specifications

1. DATA AND DOCUMENTATION

Code	Description	Measures mm	Quantity cf.	Weight (kg/cf.)	Pkg. / Pallet
ZIN33-1794	Window profile with 6 mm mesh	2.400	72 m (30 bars)	8	40 cf. / 1,200 m.
ZIN33-1795	Window profile with 6 mm strong mesh	2.400	144 m (60 bars)	16	80 cf. / 2,400 m.
ZIN33-1796	Window profile with 9 mm mesh	2.400	72 m (30 bars)	8	40 cf. / 1,200 m.

MATERIAL Made of PVC

2. DESCRIPTION

PVC profile with polyethylene seals and self-adhesive tape.
Conforms to Standard UNI 1175:2018 CLASS 2D.

3. USE

Used on the window frame as a tight fitting on the plaster sash. It is equipped with a removable adhesive protective flap that allows the glass to be protected during smoothing.
 It promotes the reduction of thermal bridges and absorbs expansion.

PVC 3D PLUS WINDOW PROFILE WITH MESH

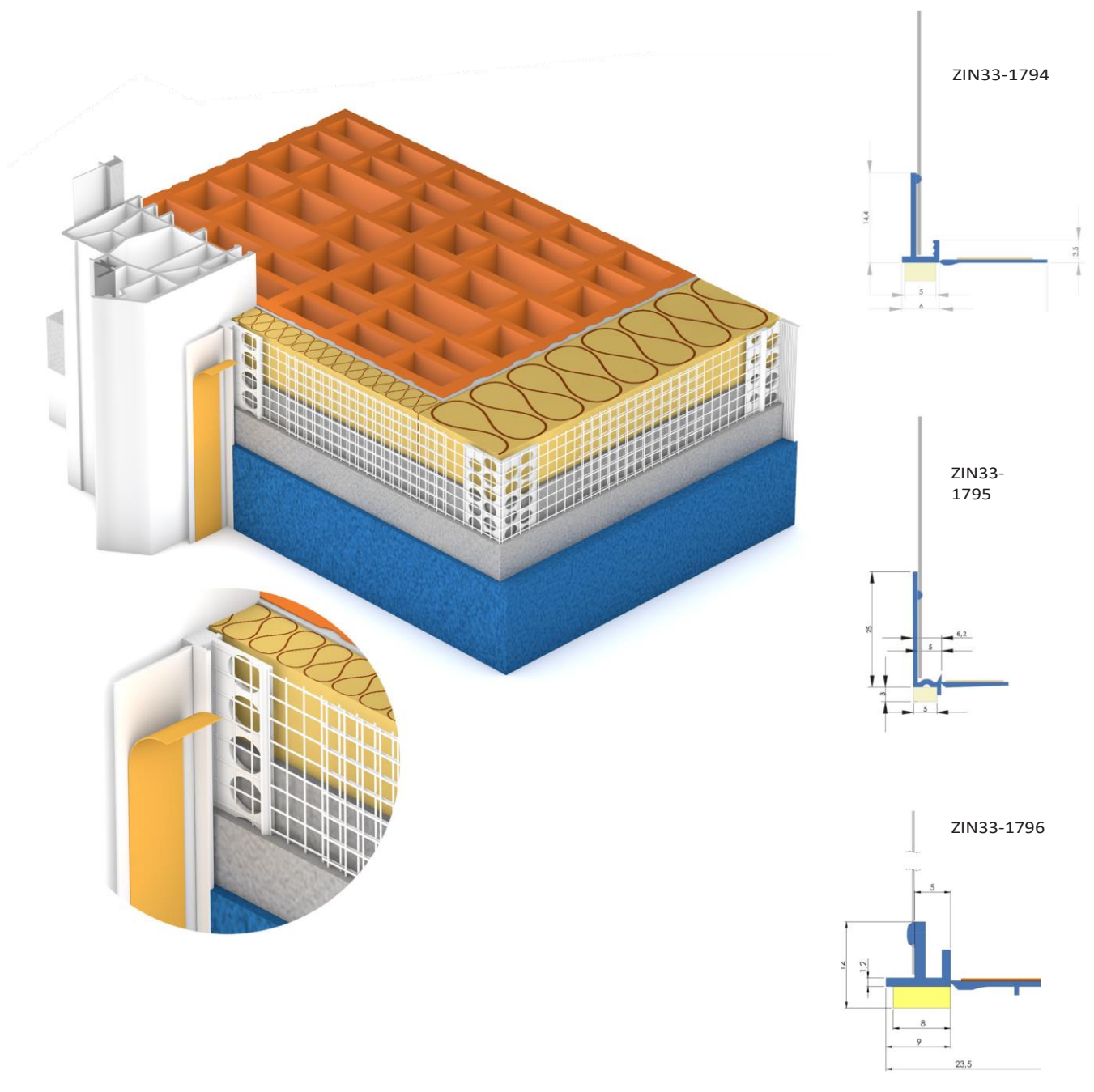

4. SPECIFICATION ITEMS

Entry	Description	U.M.	Price
Dak.B.ZIN33.179x	PVC profile fitted with polyethylene seals and self-adhesive tape. Conforms to Standard UNI 1175:2018 CLASS 2D.		
Dak.B.ZIN33.1794	Dimensions 2,400 mm.....	cf.	-
Dak.B.ZIN33.1795	Dimensions 2,400 mm.....	cf.	-
Dak.B.ZIN33.1796	Dimensions 2,400 mm.....	cf.	-