

# GREY PVC ANGLE WITH YELLOW MESH BRANDED MAGNUM

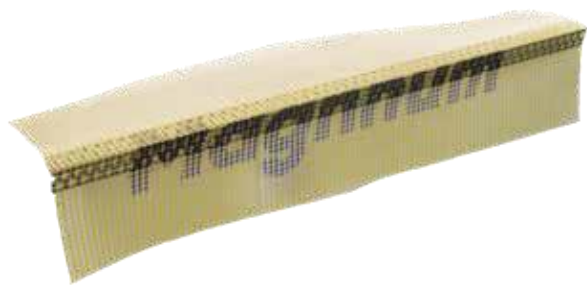

## INDEX

1. Data and Documentation
2. Use
3. Specifications

## 1. DATA AND DOCUMENTATION

Code	Description	Dimensions (mm)	Weight	Colour	Pkg. / Pallet
ZIN33-1664EGU	PVC corner piece + yellow netting 100 x 100 EKO 'Magnum' branded	100 x 100 x 2,500		-	125 m / 45 cf.

**MATERIAL** Made of PVC and fibreglass mesh.

ZIN33-1664EGU

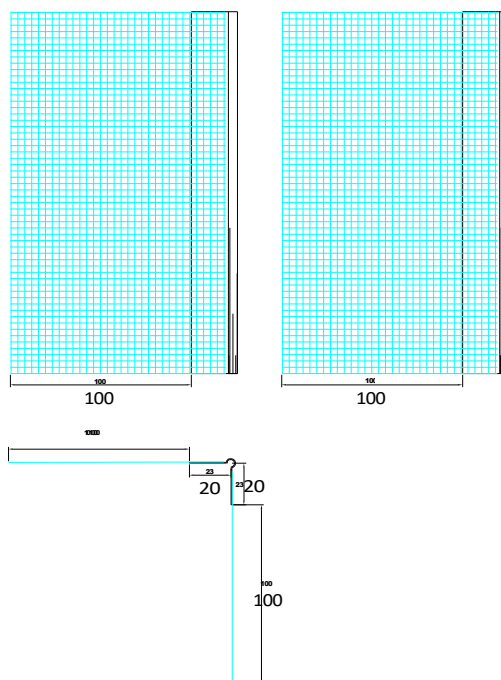

# GREY PVC ANGLE WITH YELLOW MESH BRANDED MAGNUM

Features	Units of Measurement	RET01-1159 - RET01-1159B	
		Warp	Plot
Setting	for 10 cm	20 x 2	20
Weight per thread (Tex)	gr/1000 m	136	204
Standard Height	cm	100	
Roll length	m	50	
Thickness Treated Fabric	mm	0,55	
Raw Fabric Weight	g/m2	96	
Thickness Treated Fabric	min g/m2	120	
Fuel Content (LOI)	% of mass	18	
Treatment Type		Alkali-resistant without emollients	
Dimensions Wheelbase	mm	4,1 x 4,1	

Tensile strength (TS) and elongation:

Minimum tensile strength (N/50 mm) and maximum elongation (%) is ascertained according to DIN EN ISO 13934-1 as follows

Deposition method	Traction resistance		Elongation
	Nominal Value	Individual Value	Average Value
Standard Conditions	1.800 / 1.600	1.500 / 1.200	3,5 / 3,5
Solution 5% NaOH	1.100 / 900	800 / 650	3,5 / 3,5
Quick Test	1.300 / 1.000	1.000 / 800	3,5 / 3,5

**Tolerances:**

- Setting: ± 5% in Warp and Weft
- Height: ± 1%
- Length: ± 2%
- LOI: ± 4%

**Quality Inspection**

The mode of quality control, taking samples and taking the material, is according to standard 0326 works. **Packing:**

The rolls are packed vertically in cardboard boxes on a pallet. **Warehouse:**

Rolls must be stored in a dry place. Storage temperature -10 °C to + 50 °C.

## 2. USE

Used as a sealing joint between the insulation panel and the cover profile for under sills, door and window marbles, roller shutter boxes, etc.

Applied as a reinforcement of external house corners and edges, the PVC angle with mesh allows for continuity of the mesh and greater protection of the corner itself.

It should be applied prior to the application of the reinforced skim coat.

The PVC profile with a fixed internal angle is to be applied on the insulation boards with a smoothing compound over the entire surface.

The joints must be overlapped with the mesh by 10 cm (where possible). The inner reinforcement must be removed for this purpose.

The layer of reinforced smoothing must be applied in strips of the width of the net, ensuring that the edges of the vertically adjacent nets overlap by at least 10 cm.

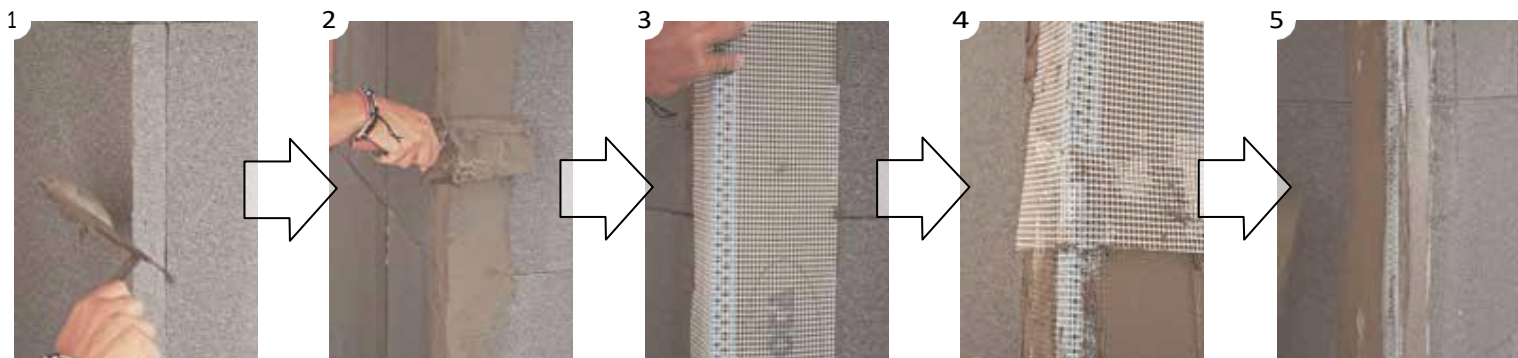

1. Apply a layer of skim coat to the insulating panels of the insulation system.
2. Complete the application of the skimming compound evenly over the entire surface of the corner. This treatment ensures a secure hold of the angle to the panel.
3. Position the product until it fits perfectly on the corner.
4. Bury our angle bracket in the levelling compound. Any joints of the corner joint must always be made for the 10 cm overlap indicated above.
5. Finish shaving until the work is completed according to the rules of art.

# GREY PVC ANGLE WITH YELLOW MESH BRANDED MAGNUM

### 3. SPECIFICATION ITEMS

Entry	Description	U.M.	Price
<b>Dak.B.ZIN33.166x</b>	<p>Supply and installation of corner protection with glass fibre mesh. The mesh can be the same as that used for the cladding.                      Made of grey PVC and 120 g/m<sup>2</sup> yellow glass fibre mesh (R96).                      The product must be laid with the mesh placed in the layer of adhesive, taking care that it is perfectly embedded, using a notched trowel or float for this purpose. Before laying the material, the substrate must be previously prepared, clean, flat and dimensionally stable. Embed the angles in the levelling compound and, once hardened, cover with a further coat of levelling compound.                      The corner should be firmly fixed to the corner of the structure also with adhesive, the overlaps with the mesh should never be less than 10 cm. The surfaces thus obtained and the corner itself must be further smoothed and levelled in order to receive, once cured, the additional coat of gravel plaster and paint.                      This is used to maintain a uniform tensile strength throughout the structure of the building's insulation package.                      On site, the product must be delivered in cardboard boxes, bearing a control code.</p>		
<b>Dak.B.ZIN33.1664EGU</b>	Dimensions 100 x 100 x 2,500 mm.....	cf.	-