

# DK-FIX CYLINDER EPS



## INDEX

1. Data and Documentation
2. Description
3. Use
4. Suitable loads
5. Thermal conductivity
6. Specifications

## 1. DATA AND DOCUMENTATION

Code	Description	Dimensions (mm)	Weight (kg / m <sup>3</sup> )	Colour	Pkg. / Pallet
ZIN35-1759/6	DK-FIX EPS cylinder	60 x 90	160	White	25 pcs. / - pcs.
ZIN35-1759/8	DK-FIX EPS cylinder	80 x 90	160	White	15 pcs. / - pcs.
ZIN35-1759/10	DK-FIX EPS cylinder	100 x 90	160	White	15 pcs. / - pcs.
ZIN35-1759/12	DK-FIX EPS cylinder	120 x 90	160	White	10 pcs. / - pcs.
ZIN35-1759/14	DK-FIX EPS cylinder	140 x 90	160	White	10 pcs. / - pcs.

**MATERIAL** Cylinder made of PU (polyurethane).

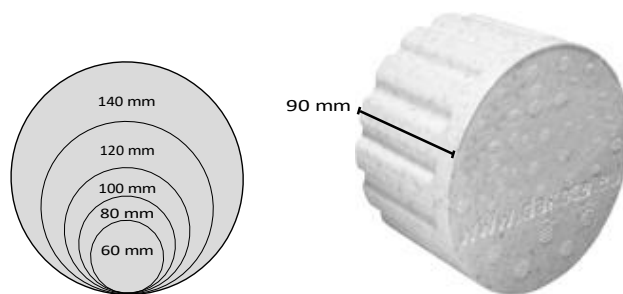

## 2. DESCRIPTION

EPS DK-FIX cylinders are particularly suitable for the external installation of elements without thermal bridges, both in expanded polystyrene (EPS) and rock wool thermal insulation systems. They also function as a support shim in the case of intermediate loads. DK-FIX cylinders are expansion-moulded EPS cylinders with a high specific weight.

## 3. USE

Used for the insertion of medium load elements.

For the screw connections in the DK-FIX cylinders, wood screws or sheet metal screws (0.15 kN (approx. 15 kg)), with cylindrical or coarse thread (adjusting screws) can be used.



# **DK-FIX CYLINDER EPS**



# DK-FIX CYLINDER EPS

## 4. SUITABLE LOADS

DK-FIX is suitable for

- Pipe clamps, gutters
- Stops and latches
- Hanging objects
- Number plates, advertising signs
- Outdoor lights, alarms, cameras

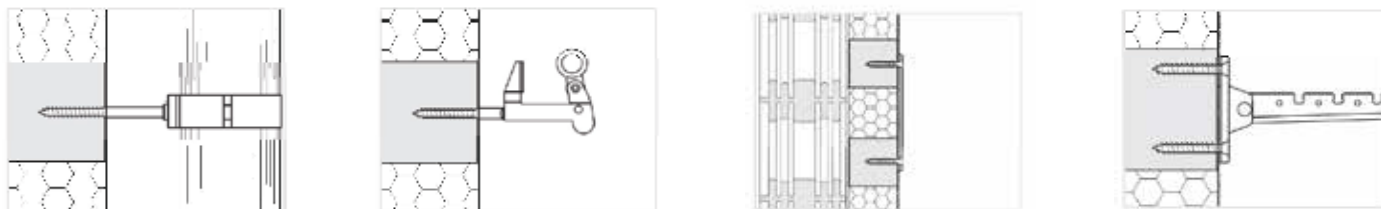

## 5. THERMAL CONDUCTIVITY

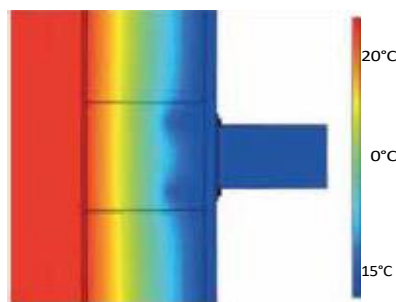

**Features**

Fire behaviour according to DIN 4101: B2

**Heat transfer**

Thermal conductivity  $\lambda$   
(measured value): 0.051 W/mK

Overall coefficient of heat transfer reference point [w / k] Following EOTA Technical Report TR 025

0 mm	60	80	100	120	140	160	180	200	220	240	260	280	300
100 x 100	6.70	5.05	3.77	2.79	2.08	1.60	1.29	1.12	1.04	1.00	0.96	0.88	0.70
150 x 100	8.10	6.20	4.69	3.54	2.69	2.10	1.71	1.48	1.36	1.30	1.25	1.17	1.00

## 6. SPECIFICATION ITEMS

Entry	Description	Unit	Price
<b>Dak.B.ZIN35.1759/n</b>	Supply and installation of DK-FIX cylinders for the external mounting of medium-load elements. Measurements 90 x 60 - 80 - 100 - 120 - 140 mm Packaged in boxes. Cylinder made of high-density EPS (polystyrene) Used for inserting medium-load elements. Recommended load capacity with wood or sheet metal screws 0.15 kN (approx. 15 kg).	pc.	-
<b>Dak.B.ZIN35-1759/6</b>	DK-FIX Cylinder EPS 60 x 90.....	pc.	-
<b>Dak.B.ZIN35-1759/8</b>	DK-FIX Cylinder EPS 80 x 90.....	pc.	-
<b>Dak.B.ZIN35-1759/10</b>	DK-FIX Cylinder EPS 60 x 100.....	pc.	-
<b>Dak.B.ZIN35-1759/12</b>	DK-FIX Cylinder EPS 60 x 120.....	pc.	-
<b>Dak.B.ZIN35-1759/14</b>	DK-FIX Cylinder EPS 60 x 140.....	pc.	-



# **DK-FIX CYLINDER EPS**

**BUILDING**

