

EXTENSIONS FOR ARKIMEDE 35-60 AND ANTI-NOISE RUBBER SHIM

Code	Description	Lenght (mm)	Weight (kg)	Pallet
TER09-1143/P25	Adjustable support - Extension 25 mm	25 - ø 112 mm	0,044 kg/pz.	90 box
TER09-1143/P50	Adjustable support - Extension 50 mm	50 - ø 112 mm	0,072 kg/pz.	54 box
TER09-1143/P100	Adjustable support - Extension 100 mm	100 - ø 112 mm	0,16 kg/pz.	20 box
TER09-1143/G	Anti-noise rubber Shim	ø 120 - thick 2	0,018 kg/pz.	72 box.

TER09-1143/P25

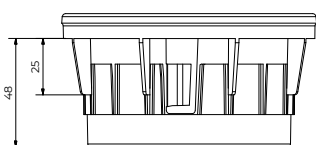

TER09-1143/P50

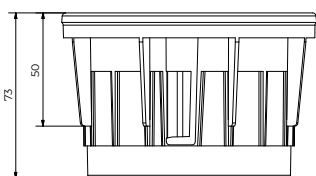

TER09-1143/P100

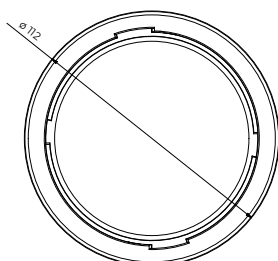
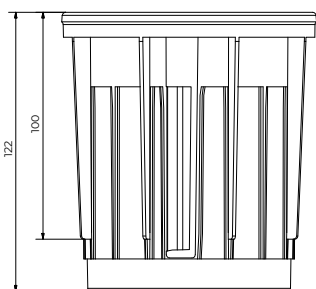

TER09-1143/G

